

MUNICIPALITY OF MONROEVILLE
ALLEGHENY COUNTY, PENNSYLVANIA

ORDINANCE NO. 2275

**AN ORDINANCE OF THE MUNICIPALITY OF MONROEVILLE ACCEPTING
JEFFERSON COURT**

NOW, THEREFORE, BE IT ORDAINED AND ENACTED by the Council of the Municipality of Monroeville, County of Allegheny, Commonwealth of Pennsylvania, and it is hereby ordained and enacted by the authority of the same as follows:

Section 1. The Municipality of Monroeville hereby accepts the dedication of Jefferson Court in the Ridgeview Estates Plan of Lots and a total distance of 0.06 miles as more particularly described on Exhibit "A" attached hereto.

Section 2. All Ordinances or Resolutions or parts of Ordinances or Resolutions in conflict herewith are hereby repealed.

ORDAINED AND ENACTED into law the 11th day of November, 2003.

MUNICIPALITY OF MONROEVILLE

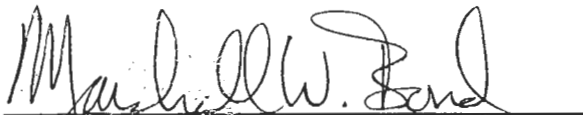

Marshall W. Bond
Municipal Manager

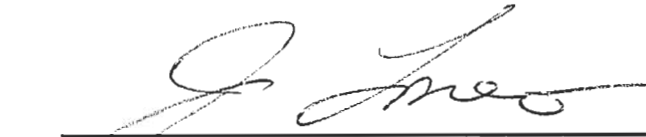
James J. Lomeo
Mayor

**JEFFERSON COURT
STREET ACCEPTANCE
LAND DESCRIPTION
EXHIBIT "A"**

The Municipality of Monroeville hereby accepts the dedication of Jefferson Court as shown and laid out in Ridgeview Estates Plan of Lots, more fully described as follows:

FROM A POINT OF BEGINNING on Mallard Drive west 503.97 feet from the intersection of Golfridge Drive and Mallard Drive, being a right-of-way having a width of 50 feet, thence north $22^{\circ}24'07''$ west a distance of 119.16 feet, thence to a point curving to the left at a radius of 125.00 feet and an arc length of 128.52 feet, thence north $81^{\circ}18'45''$ west a distance of 64.30 feet, thence south $08^{\circ}41'15''$ west a distance of 25 feet to the center of a cul-de-sac with a radius of 50.00 feet.

The Municipality of Monroeville hereby accepts for municipal purposes all of the storm water sewers servicing the lots adjacent to the streets herein above described and located within the said street right-of-way or adjacent lots together with any easement and additional right-of-way therefore shown on said plan, to be part of the storm water sewer of the Municipality of Monroeville. The grades for the streets accepted hereunder are hereby established as the existing grades, reserving however the Municipality of Monroeville the right to change such grades without liability to adjacent property or property owners thereof.

INFRASTRUCTURE PLAN RIDGEVIEW ESTATES

MUNICIPALITY OF MONROEVILLE
ALLEGHENY COUNTY, PA
JUNE 31, 2003

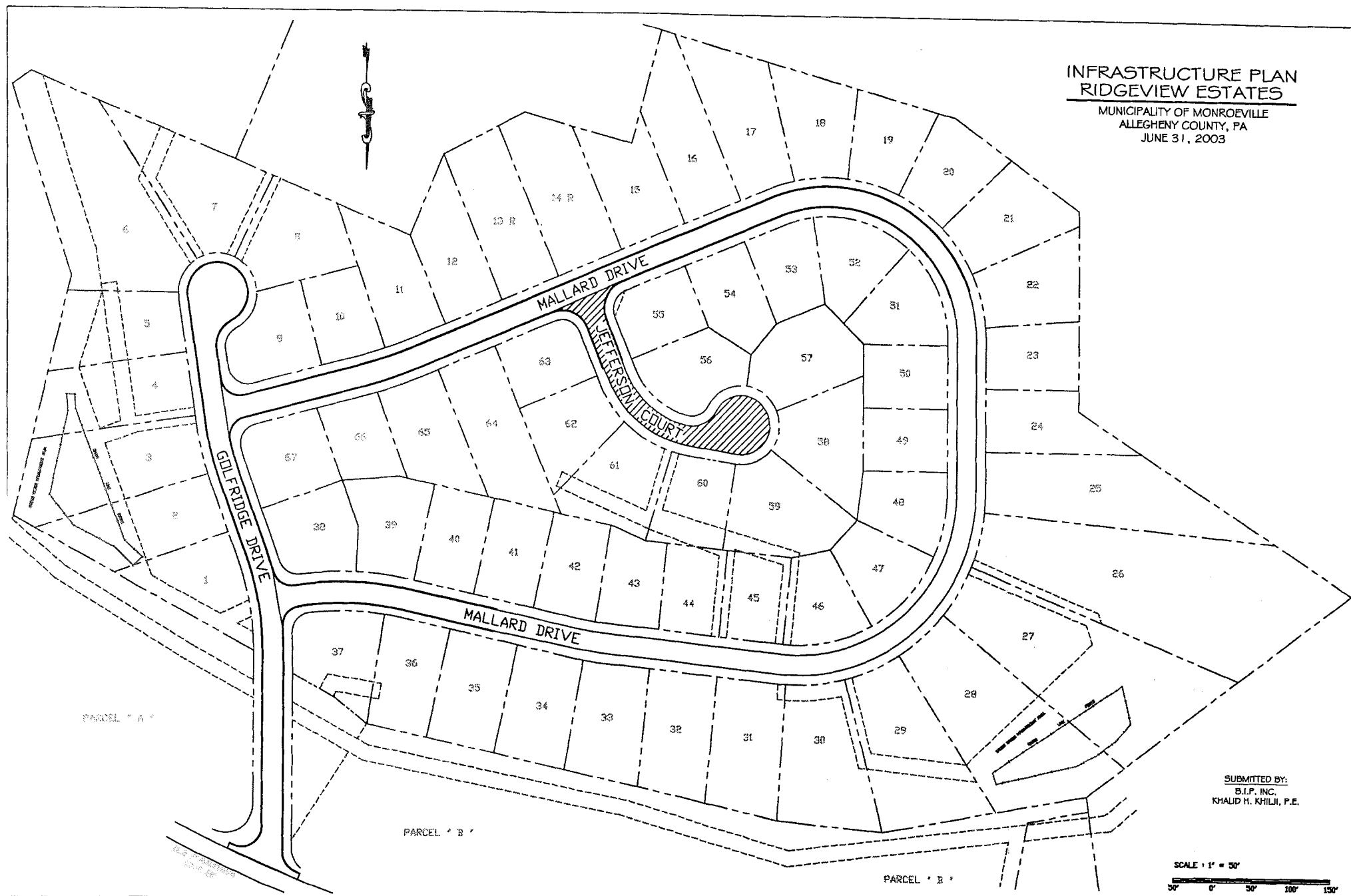

SUBMITTED BY:
B.I.P. INC.
KHALID H. KHILJI, P.E.

SCALE: 1" = 50'
50' 0' 50' 100' 150'